

www.groutpower.com

GROUT Power



GROUT System

SLURRIES, MICROMORTARS AND STRUCTURAL MORTARS FOR GROUTING, REINFORCEMENT AND STRUCTURAL CONSOLIDATION

(lime-based - cement-based - structural castables - structural castables with metallic micro-wire - structural castables with rapid curing)

- Bolstering reinforced concrete pillars, beams and crosspoints.
- Restoring edge beams, dossierets and technical joints in road infrastructure.
- Connecting seismic insulators to the foundation structures.
- Fastening connectors, pins, clamps, bars and reinforced seams.
- Precision anchors for heavy machinery characterised by significant dynamic stresses during the operational phases.
- Grouting micropiles in foundation structures.
- Injections on tie rods and sheaths in post-tensioned structures.
- Anchoring snow barriers, rockfall barriers and containment nets on slopes subject to landslide.
- Saturating damages and filling cracks on reinforced concrete components.
- Constructing impervious structures.
- Overall or precise consolidation of masonry structures in historic buildings.



Find out more at:
www.groutpower.com

AZICHEM production has 6 practical lines, listed below, for wide-ranging construction and renovation needs.

Find out more at: www.azichem.com



GROUT Power

Curing and thixotropic structural mortars, chemical anchoring, shaving and stucco, nets and accessories

STRUCTURAL OPERATIONS

ANCHORING, FASTENING, REINFORCEMENT AND CONSOLIDATION



IF YOU WANT TO SOLVE IT
azichem[®]

Via G.Gentile 16/A 46044 - Goito (MN) Italy
Ph. +39 0376.604185 - Fax +39 0376.604398
info@azichem.com - www.azichem.com

IF YOU WANT TO SOLVE IT
azichem[®]

GROUT POWER: 3 families of high-performance products for a variety of design contexts.

www.groutpower.com

GROUTPower



GROUT POWER encapsulates the most advanced technologies and the greatest advantages developed by AZICHEM in **cement-matrix composites**, in **natural lime-based and composite systems**:

GROUTSystem: Products that are castable, anti-shrinkage, high technology, cementitious and/or lime-based for structural consolidation, sealing and reinforcement.

RINFORSystem: Structural mortars and microconcretes, in combination with mesh and bars in glass and/or other specific accessories for reinforcement, improvement and seismic adaptation of flooring, masonry and concrete structures.

FLOORTECHSystem: Cementitious products and innovative technologies, specifically designed for new industrial flooring in concrete and to restore existing paving.

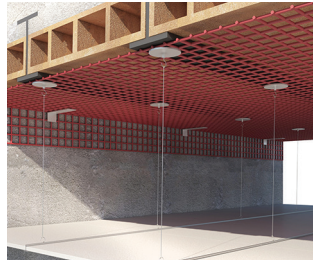

CHARACTERISTICS AND BENEFITS

In the restoration of existing works:
SMALL SCALE OF THE RESTORATION.

In newly-built structures:
HIGH MECHANICAL RESISTANCE FOR REDUCING THE DIMENSIONS OF THE LOAD-BEARING ELEMENTS.

In restoration and new works:
HIGH DEFORMATION AND RESIDUAL STRENGTH VALUES DUE TO THE ADDITION OF FIBRES AND SPECIAL FORMULATIONS OF THE "MIX DESIGN".

Harsh environmental exposure:
PHYSICO-CHEMICAL PERFORMANCE EVEN AFTER A BRIEF CURING - DURABILITY OF THE WORK.

RINFORSystem

PRODUCTS AND SYSTEMS FOR SECURING SLABS AND MASONRY

- Slab with mesh and connectors to prevent detachment.
- Slabs with mesh, connectors and fibre-reinforced composite mortar to prevent detachment.
- Anti-overturning masonry with mesh, connectors and fibre-reinforced composite mortar.
- Reinforced pointing of joints with helical stainless-steel bars and fibre-reinforced adhesive mortar.

FIBRE-REINFORCED MICROCONCRETES FOR STRENGTHENING, REPAIR AND SEISMIC ADAPTATION OF STRUCTURES

- Thin extradosal reinforcement layer in micro High-Performance Fibre-Reinforced Concrete (HPFRC) for masonry-cement slabs and mixed iron beam and masonry or wooden slabs.
- Thin reinforcement casing with micro High-Performance Fibre-Reinforced Concrete (HPFRC) for reinforced concrete structures: pillars, beams and beam/pillar crosspoints.

FLOORTECHSystem

PRODUCTS AND TECHNOLOGIES FOR CONCRETE FLOORING

- Non-reinforced concrete flooring;
- Reinforced concrete flooring;
- Fiber-Reinforced Concrete (FRC) flooring with conventional reinforcement;
- FRC flooring without conventional reinforcement

NEWLY-CREATED FLOORING

- Concrete fibres
- Mineral additions (microsilicates, silica fume)
- High-performance cement dusting
- Sealants for joints
- Perimetral insulation strip
- Surface treatments

RESTORATION OF OLD FLOORING

- Thin adhesive screeds
- Medium-thickness adhesive screeds
- Adjustment levels